

11190 EV-LEDFIRE-BASIC

Ektor Ledfire Basic Emergency Luminaire can be installed in either accessible or inaccessible ceiling cavities. To install the Ledfire Basic please follow the steps listed below and heed the safety warnings.

1

Remove the product from the box and inspect it for any damage. If you believe the product to be damaged or otherwise unsound, **DO NOT** install the product. Please pack it back into its box and return it to the place of purchase for replacement. If the product is satisfactory, proceed with the installation.

2

Choose the hole diameter that is suitable for your application. If the hole is bigger than 80mm you will have to install the outer ring and must see step **A** before continuing to step **3**.

3

INSTALLATION

Drill the hole in the ceiling to suit your dish size. Insert the plug into the cavity first.

Pull the spring clips up, insert and release the spring clips, ensuring that the dish is secure and flush up against the ceiling.

ø 75 mm - 130 mm with outer ring
ø 70 mm - 80mm without outer ring

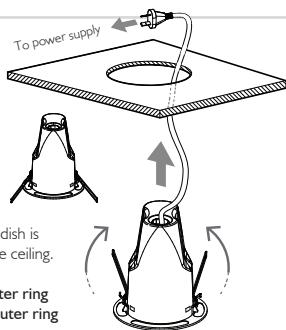

A ADDING THE OUTER RING

Add the outer ring by pulling the springs up and sliding it down the body and twisting it into its locking position.

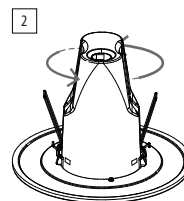
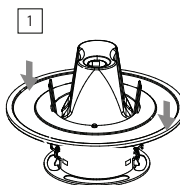

WARNING

The Ektor Ledfire Basic Emergency Luminaire is connected to an unswitched active during normal operating conditions. When disconnected from the mains supply, the Ledfire Basic is powered by a LiFePO4 battery operated inverter. Due to this, care should be taken when replacing either the battery or dish.

SAFETY WARNINGS

1. THIS PRODUCT MUST ONLY BE INSTALLED BY A LICENSED ELECTRICIAN.
2. BEFORE COMMENCING INSTALLATION TURN OFF AND ISOLATE THE ELECTRICAL SUPPLY.
3. DO NOT ENERGISE WITH PRODUCT OPEN OR DISASSEMBLED.
4. SUPPLY VOLTAGES WITHIN PRODUCT. ISOLATE SUPPLY VOLTAGES BEFORE OPENING OR SERVICING.
5. THERE ARE NO USER SERVICEABLE PARTS.
6. DO NOT ATTEMPT TO SERVICE OTHER PARTS OF THE FITTING AS THIS WILL VOID THE WARRANTY.
7. AS THE INSTALLER, IT IS YOUR RESPONSIBILITY TO ENSURE YOU COMPLY TO ALL RELEVANT BUILDING AND SAFETY CODES FOR EXAMPLE THE BCA, AS3000. REFER TO APPLICATION STANDARDS FOR THE RELEVANT RULES.
8. WHEN THE INSTALLATION IS COMPLETE, LEAVE THIS MANUAL WITH THE BUILDING'S OWNER(S) FOR FUTURE REFERENCE.

BATTERY LIFE

To maintain the economic life of this product it is required that the battery be discharged and recharged at least once every 6 months. The battery life can be reduced if the battery is not discharged as per the requirements of AS/NZS 2293 or an equivalent standard. Increasing the number of duration tests above that as defined in AS/NZS 2293 or an equivalent standard can have a positive effect on the battery performance as long as 12 discharge cycles per year is not exceeded.

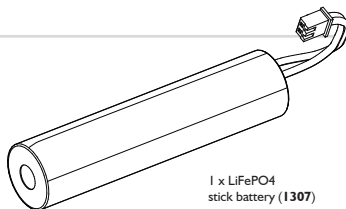

1 x LiFePO4
stick battery (1307)

DIMENSIONS

** Size without outer ring

* Size with outer ring

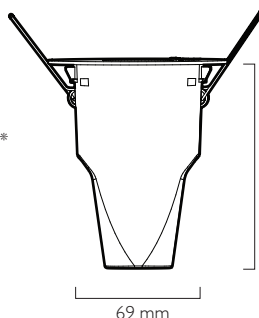
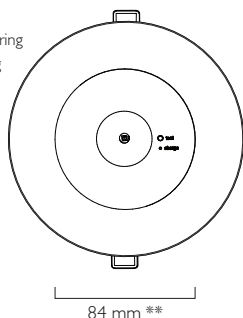

Voltage	~230 V	Mounting Type	Recessed mounting
Frequency	50 Hz	Wiring	Flex and plug
Max. Ambient Temp.	40°C		
Class	2	Battery Type	LiFePO4
Duration	90 min	Battery Voltage	3.2 V
IP Rating	IP20	Charging Time	16 hours
Emergency Classification	D25	Charger Type	Variable
Average Power Consumption	0.45 W	Max. Power Consumption	2 W

ORDERING INFORMATION



CODE	DESCRIPTION	PRODUCT NUMBER	CARTON QTY.	WEIGHT (NET/GROSS)
11190	Ledfire Basic Emergency Luminaire	9336462111901	20	-

SPACING TABLE (DISTANCE BETWEEN FITTINGS)

LUX	CLASSIFICATION	MOUNTING HEIGHT (M)																
		2.1	2.4	2.7	3	3.3	3.6	4	4.5	5	6	7	8	9	10	15	20	
0.2	D25	14.2	14.7	15.3	15.7	16.1	16.5	16.9	17.3	17.7	18.1	18.3	18.2	17.9	17.3	7.7		
0.5	D25	10.1	10.5	10.8	11.0	11.2	11.3	11.4	11.5	11.5	11.1	10.2	8.6	5.2				
1	D25	7.7	7.9	8.0	8.1	8.1	8.1	7.9	7.6	7.2	4.8	1.1						

ACCESSORIES AND SPARE PARTS

CODE	DESCRIPTION
1307	Battery 1500mAh Cell LiFePO4

	STANDARD	TITLE
Australian/ New Zealand Standards 	AS/NZS 2293-3:2005+A1:2010	Emergency escape lighting and exit signs for buildings. Part 3: Emergency escape luminaires and exit signs.
	AS/NZS 60598-2-22:2005	Luminaires Part 2.22: Particular requirements - Luminaires for emergency lighting (IEC 60598-2-22, Ed. 3.1(2002) MOD).
	AS/NZS CISPR 15:2011	Limits and methods of measurement of radio disturbance characteristics of electrical lighting and similar equipment.
European Committee for Standardisation 	EN 60598-2-22:1998+A1:2003+A2:2008	Luminaires - Part 2-22: Particular requirements - Luminaires for emergency lighting.
	EN 55015:2006+A1:2007+A2:2009	Limits and methods of measurement of radio disturbance characteristics of electrical lighting and similar equipment.
	EN 61547:2009	Equipment for general lighting purposes - Electromagnetic compatibility (EMC) immunity requirements.

CONSTRUCTION SITES

IMPORTANT NOTE: Continuously switching the power supply to the fitting on and off during or after the installation process due to other processes being conducted on the building site could cause the fitting to discharge and charge its battery many times during a short period which can impact negatively on the battery life. It is not recommended that you connect the Ektor emergency products to the power supply if such conditions are prevalent. If you choose to expose the Ektor emergency products to such harsh operating conditions, Evolt may not honour any warranty on the life of the batteries or the dish. This Ektor emergency product is designed to undergo regular discharge tests but it is recommended that the intervals between consecutive tests are not less than two weeks. Frequent testing of the exit product will reduce the service life of the battery. In order to prevent damage to the battery, leave the unswitched active circuit turned off at the circuit breaker until such time as emergency lighting is required

TESTING PRECAUTIONS

When the Ektor emergency product is permanently connected to the mains supply you will need to allow 24 hours to charge its battery. Once the battery is fully charged you will need to conduct a manual discharge test as per the requirements of AS/NZS 2293 or other relevant standards. At the time of printing, the Australian standard requires that new fittings operate in emergency mode for at least 2 hours for their first discharge test. Further tests are to be carried out at intervals of not more than six months. It is important that you keep records of the initial test and ongoing tests in the building's emergency service logbook. If the fitting is not to be permanently connected to the mains supply at the time of installation, you must give it the mandatory 2 hour test when you connect it permanently to the mains supply.

WARRANTY STATEMENT

Ektor products are distributed in Australia and New Zealand by Evolt Pty Ltd (Evolt). The Australian Consumer Law as well as other Australian laws guarantee certain conditions, warranties and undertakings, and give you other legal rights, in relation to the quality and fitness for purpose of Ektor products sold in Australia. In Australia, our goods come with guarantees that cannot be excluded under the Australian Consumer Law. You are entitled to a replacement or refund for a major failure and compensation for any other reasonably foreseeable loss or damage. You are also entitled to have the goods repaired or replaced if the goods fail to be of acceptable quality and the failure does not amount to a major failure. What constitutes a major failure is set out in the Australian Consumer Law. Nothing in this Warranty purports to modify or exclude the conditions, warranties and undertakings, and other legal rights, under the Australian Competition and Consumer Act and other Australian laws. Ektor products are warranted in Australia for a period of 12 months from the date of delivery of the product, provided that the products are properly stored, installed, used and maintained in accordance with the instructions contained within their manual. Products that have been altered in any way or used other than in accordance with their instructions are not covered by this warranty.

This warranty is not transferrable and is valid only in the hands of the purchaser of the product. The warranty does not cover Ektor products other than those purchased from Evolt. Proof of purchase must be provided to Evolt with any warranty claim. Evolt recommends that the purchaser attaches their proof of purchase to their product manual. Evolt's total liability under this warranty is limited to the cost of repair or replacement of the faulty product. Evolt may satisfy its obligations under this warranty in full by repair or replacement of a faulty product. This warranty does not apply to consumable items such as lamps or batteries or other items that can be classified as consumable. For the avoidance of any doubt, any and all warranties or conditions which are not guaranteed under the Australian Competition and Consumer Act or the Australian Competition and Consumer Regulations 2010 and which are not expressly included in this Warranty as additional warranties or conditions are excluded. This Warranty does not cover loss or damage caused by wear and tear, misuse, incorrect installation or operation, failure to clean and maintain, incorrect voltage or non-authorized electrical connections, adverse external conditions (such as power surges and dips, acts of God, exposure to heat, corrosion, insect or vermin infestation), use of non-authorized or defective parts or globes, or to items that have been repaired other than by Evolt or a repairer approved by Evolt.

TECHNICAL SUPPORT AND TROUBLESHOOTING

For further assistance in using this product, consult your nearest wholesaler or Evolt Pty Limited.